

Everyday Roller Blind Installation Instructions

What is supplied with your blinds



Single blind control bracket



Single blind idle bracket



Dual blind control bracket (L) and idle bracket (R)



Child safety warning label



Child safety chain retainer



Ball stops, 2 per blind (optional)

Required tools:



Metal tape measure in mm



Spirit level or laser level



Pencil



Phillips head screw driver number 2 tip



Phillips head impact driver number 2 tip



Impact driver & drill if you are fixing to masonry

You may also need:

- Drill bits
- Red wall plugs
- Hollow wall anchors

Fixing options:

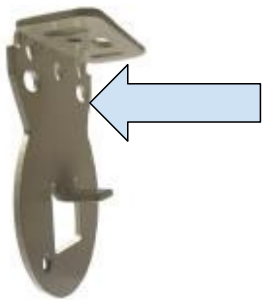

Side fix (also know as 'recess fit' or 'reveal fit')



Top fix

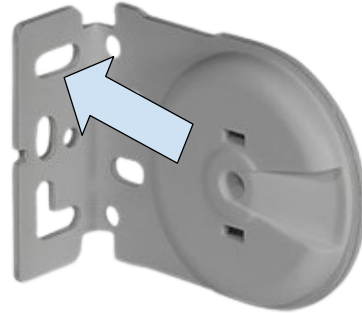

Face fit

NOTE: A minimum of 2 screws per bracket is strongly recommended, even in situations where it appears 1 screw will hold.

Installing inside the window frame (Recess Fit):

- Recommend fixings:
 - For timber, 8G x 40mm Button Head Stitching Timber Screws
 - For Aluminum, 8G x 16mm self drill button head screws.
 - For masonry, 8G x 40mm Button Head Stitching Timber Screws with red wall plugs.
- Check for any obstructions such as window frame parts and window winder handles that could prevent the blind from getting to the bottom of the window and set the brackets so the blind can travel freely to the bottom.
- Position the bracket in the desired location and using a suitable fixing:
 - For timber and aluminium, drive the screw in with an impact driver.
 - For masonry, mark the hole locations, drill the holes, fit the plugs, then fit the bracket.
- Use a spirit or laser level to check that the blind is level. If it is not level, use packers - cut up pieces of window packers work - to lower the appropriate bracket to bring the blind into level. We recommend starting with 2 or 3 millimetre packers.

Installing outside the window frame (Face Fit)

- Fitting to timber architraves:
 - Position the control end bracket at the top corner where you've originally measured the blind. Mark the inside of the holes (as far

from the edge as possible) with a pencil. Remove the bracket and pre-drill the holes with a 3mm drill.

- Screw the bracket gently to the architrave. Be careful not to split the timber. Also be wary if the architrave is fitted over masonry, concrete or render - if the screw goes through to the back, it will want to push the architrave away towards the room.
- Repeat for the idle side bracket, using a spirit or laser level to ensure the control and idle brackets are level. If the distance between brackets is too big for a spirit level and you don't have a laser level, use one screw in the idle end (use the area on the bracket that allows for up and down adjustment) to hold it in the approximate position, then fit the blind and get the level from the top of the blind, then adjust the idle side bracket to bring the blind into level - make sure the second screw goes into the idle bracket.

Fitting the blinds into the brackets



Install the control end first, making sure that the enclosed top of the chain drive is facing up. Rotate the blind as you insert it into the bracket so it aligns with the metal piece on the bracket.



Place the other (idle) end of the blind into the other bracket by swinging the blind into position - the idle end bracket has a 'ramp' to facilitate the pin to enter the hole. You may need to retract the pin - this is done by rotating clear plastic cog anti clockwise.

Fitting the Cord Retainer:

Australian Law requires that a Cord Retainer be attached to the wall or window frame in order to prevent children wrapping the chain around their necks. The legislation states "Corded blinds and curtains must be installed in a way that ensures a loose cord cannot form a loop 220 mm or longer at or less than 1,600 mm above floor level."

We recommend fitting the chain safe in the following manner:

- Fit the chain safe to the chain, making sure that the chain is not twisted and that the chain safe is oriented toward its fixing point as per the pic below.
- Let go of the chain and allow the chain to settle in its natural position.
- Raise the chain safe approx 50mm and position it away from the edge of the fabric - toward the window if space allows.
- Secure the chain safe with a suitable fixing.



Fitting the optional ball stops:

2 ball stops per blind are supplied, fitting these is optional. Why is it optional?

- Ball stops are used to prevent blinds from being rolled too far. As blinds give plenty of feedback when being rolled too far, ball stops are not a necessity.
- It's obvious when the blind is lowered too far down in recess fit situations because the base bar of the blind hits the bottom of the recess.
- It's obvious when the blind is raised too far because the base bar tries to wrap itself around the top of the blind.

At a minimum, we recommend that ball stops be fitted when:

- There is a large face fit blind and there is no flooring or window sill to provide feedback on where the bottom is. In this situation, at a minimum, we recommend a lower limit ball stop.
- Young children or impaired adults are to be operating the blinds.
- In rental properties.

To fit the ball stops (see images below):

Upper stop limit:

- Raise the blind to where you'd like it to stop.
- For front roll, fit the ball stop on the side closest to you, for back roll, fit the ball stop on the side furthest away from you.

Lower stop limit:

- Lower the blind to where you'd like it to stop.
- For back roll, fit the ball stop on the side closest to you, for front roll, fit the ball stop on the side furthest away from you.

Note: Fitting the ball stop at the back of the blind can be a little bit of trial and error. We recommend using a pair of pliers to remove the ball stop if needed; usually re-installing 2 to 3 balls away from where it was is usually enough.



Image above shows a back roll installation, with the ball stop limiting the top travel limit. On front roll applications, the ball stop would be at the front of the blind. Note that the blind has been lowered to show the ball stop; You would set the blind to stop higher than in the image.



Image above shows a back roll installation, with the ball stop limiting the lower travel limit. On front roll applications, the ball stop would be at the back of the blind .

Need help?

Please contact call us on 1300 998 442

or email sales@blindmotion.com.au